

Camera Oral LED Lights

型号: TR-B

Manual

Thank you for applying TR-B camera oral LED lights. For the sake of safety and efficient use of the product, please read this manual carefully.

Catalog

Technical parameter -----1

Description of product structure
and components -----2

The machine handling instruction -----3

The sketch map of installation -----5

The procedure of installation -----6

Product after-sales service (warranty) card -----8

Product after-sales service (warranty) card

1、after you buy the product, please fill in the following information in time, and within seven working days to send the card back to the company, will be subject to the local postal, otherwise, as a user automatically give up after-sales service (maintenance).

2、before use the product, please read product manual carefully and the card.

3、Would you please fill in the receipt, or written neatly, the content is complete (customer retention).

Warranty Card:

Item Name:	BTR Camera Oral LED Light		
Model:		Machine Number:	Serial
Producing Date:		Sales Date:	
Buyer:		Number:	
Buyer Address:			
Remarks:			

4、the scope of the following does not belong to free range

To buy time for more than a year/artificial damage/don't according to the instructions in the instruction/operation failure caused by force majeure events/machine had been dismantling.

Technical parameter:

color temperature: 4000K-65000K

luminance intensity(700mm away): 5000LUX-30000LUX

video distance: 500mm-2000mm

Noise Level (dB): ≤45dp

output voltage and power: 12V/12W

Electrical Rating (V): 220V±10%

Full-automatic focus:st

magnification: 0-60X

Working life: 50000 hours

double capture (at the scene of the recording, can take photos)

double taken recording (can choose HD formats and MP4 recording)

signal format: BTSC color, PAL color

animation recording format: AVCHD - 2.0

recording pixels: 10 million pixels

The image outputs:HDMI

Image output: hd 1080 p 60 hz

continuous shooting (host) 2-24 hours continuously at the computer can infinite check continuously

many languages optional (in English and optional)

can support the storage card 8 g, 16 g, 32 g, 64 g, card can be directly transferred into computer storage

display can be shown by single and multiple displays.

Description of product structure and components:

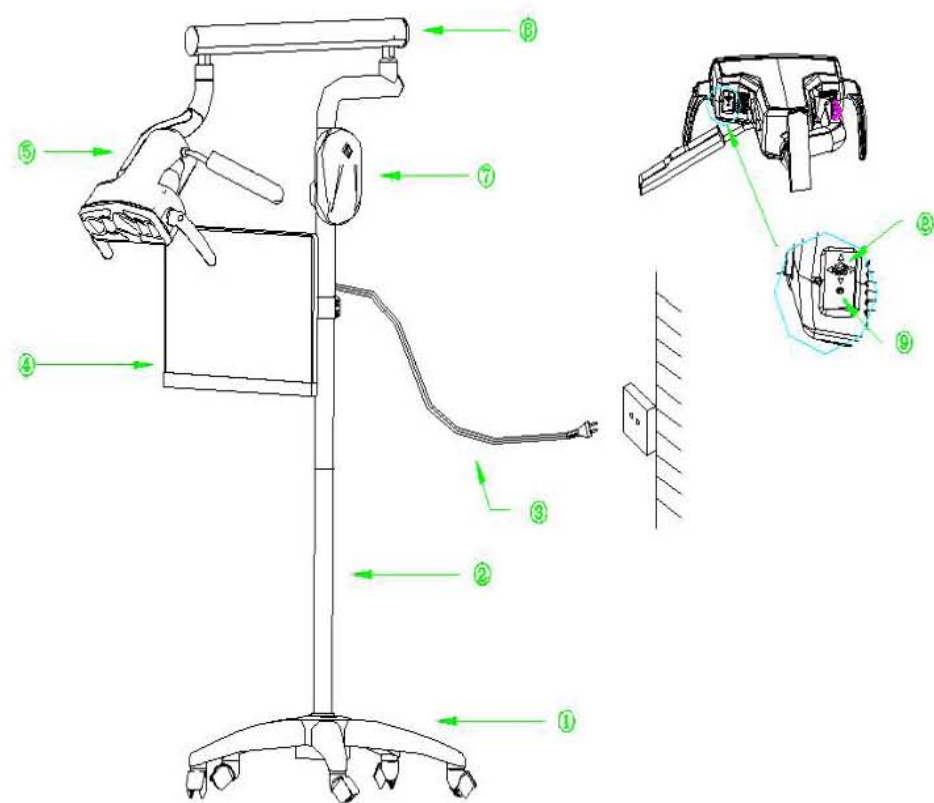

- ①---Horse
- ②--Shoring
- ③--Power Wire
- ④--Monitor
- ⑤--camera oral LED light
- ⑥---Rotational arm
- ⑦--Power box
- ⑧--function key
- ⑨--mode selection key(ESC)

② the monitor should be inserted into the black cable HDMI the following two hole behind the display. As shown in figure 7, 8



③the handle black cable connection as shown in figure 9, 10 and 11



The procedure of installation

- 1、Install all 5 truckles into the horse;
- 2、Insert the bottom of the stud into the central hole of the horse;
- 3、Get the screw across the piece of round icon, wind the screw into the bottom of the stud, then screw down it with the M8 hex key;
- 4、Connect the tow pieces of the pillar and tie up with the M5 cross head crew;
- 5、With 1.8 m long connected via a, with terminal through the gland at the end of the round hole, connecting to wear again into a pillar of the round hole, has been to guide wire into video lights. The gland on the stud, pay attention to the cable should not be gland pressure. The gland with screws and display The gland on the swing arm another part. Tighten the screws on the pillar;
- 6、Connect the plug of the rotational arm and the socekt of the stud..Infix the connector of the rotational arm into the inner hole of the stud;
- 7、Inside the arm is the plug and power cable socket docking, Screwed rotational arm and the pillar;
- 8、The shake handshandle loaded on the lamp holder;
- 9、Each data line connection diagram:

①.  — white cable should be inserted into the power behind the box, as shown in figure 5, and 6



The machine handling instruction:

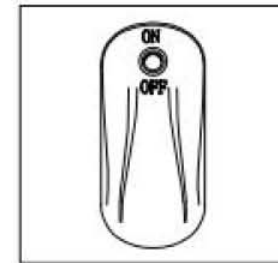

- 1、Put the attaching plug of the camera oral LED light into the power socket, and then open the power switch of the bleaching system. Figure (1)

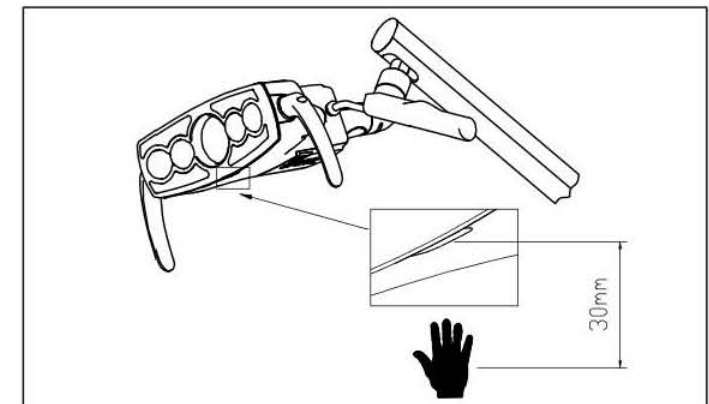

- 2、The lamp will turn on or off if you put your palms in front of the sensor and move in the range from 5-30mm. When we need to adjust the illumination of the light spot, put your palms in front of the sensor without move in range of 5-30mm (In the event of the lamp is turned on), the illumination will keep changing in 3 seconds. To achieve the ideal illumination.

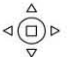

3、 Turn on the "POWER" button,the camera oral LED light has electricity while the handle POER/REC indicator light open.

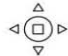
4、 There two button behind the lamp: one  is the function key, the other one  is the watch the video function.If go Into play and standby mode,According to a mode button to enter standby mode. you can set up the out put require according to your need by the key of  up (▲) and down (▼) ,left(◀)and right(▶),according to the central key to confirm.the press teh key "□" to exit to play mode.

5、 Turn on the "POWER" button,the camera oral LED light is power off while the handle POER/REC indicator is put out.

6、 On the press "PHOTO" at a time can capture the image and stored on the card at a time.

7、 Turn the "PHOTO"button to "Lock",photos can be locked.

8、 Turn the "START/STOP" button ,the camera stars to record video,again according to the exit.

9、 "T/W" switch is zoom in and out, manual control zoom in on the focal length automatically.

10、 Memory card should pay attention to in the direction,If you put wrong direction and insert the memory card forcibly, store the image data card may be damaged.In nine hours later, the suggested replacement memory cards or delete the image data in the card,Or memory cards filled with won't be able to continue to work.

11、 If you long time continuous action native machine temperature may rise,high temperature may not be able to record video,also may be shut down automatically to protect the machine.Such as machine down until the temperature may continue to work. If you have any problem or little trouble with the machine when using please Cut off the total power switch and do contact our after-sale service department. We will try our best to be help. Thank you for your support.

The sketch map of installation

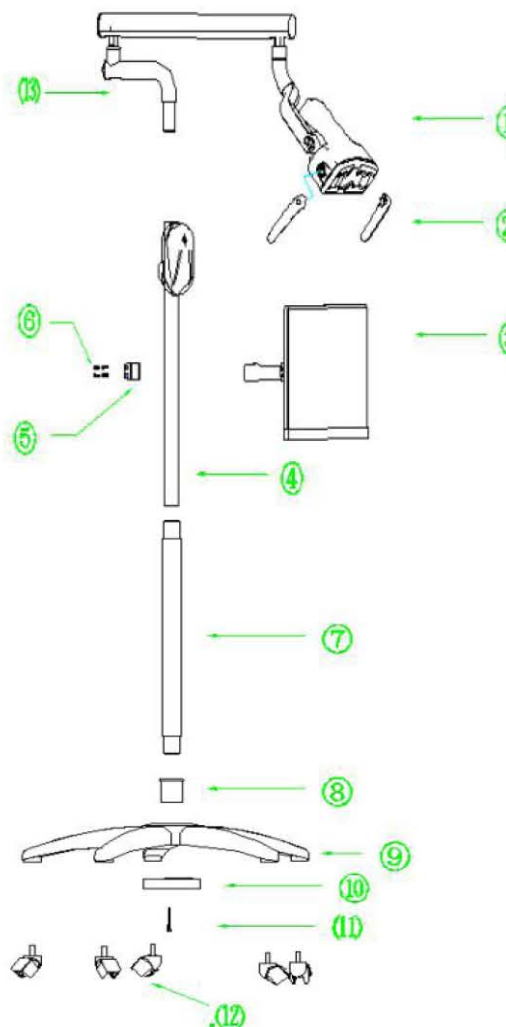

1、 Lamp	1 pcs
2、 Handles	2pcs
3、 Monitor	1pcs
4、 Pillar	2pcs
5、 Gland	1pcs
6、 Allen screw	1pcs
7、 Locating sleeve	1pcs
8、 Horse	1pcs
9、 Fixed discus	1pcs
10、 M12 screw	1pcs
11、 Truckle	5pcs
12、 Arm	1pcs